

CuraSlide™ BC

Comfort Safety IV Catheter/Blood Control





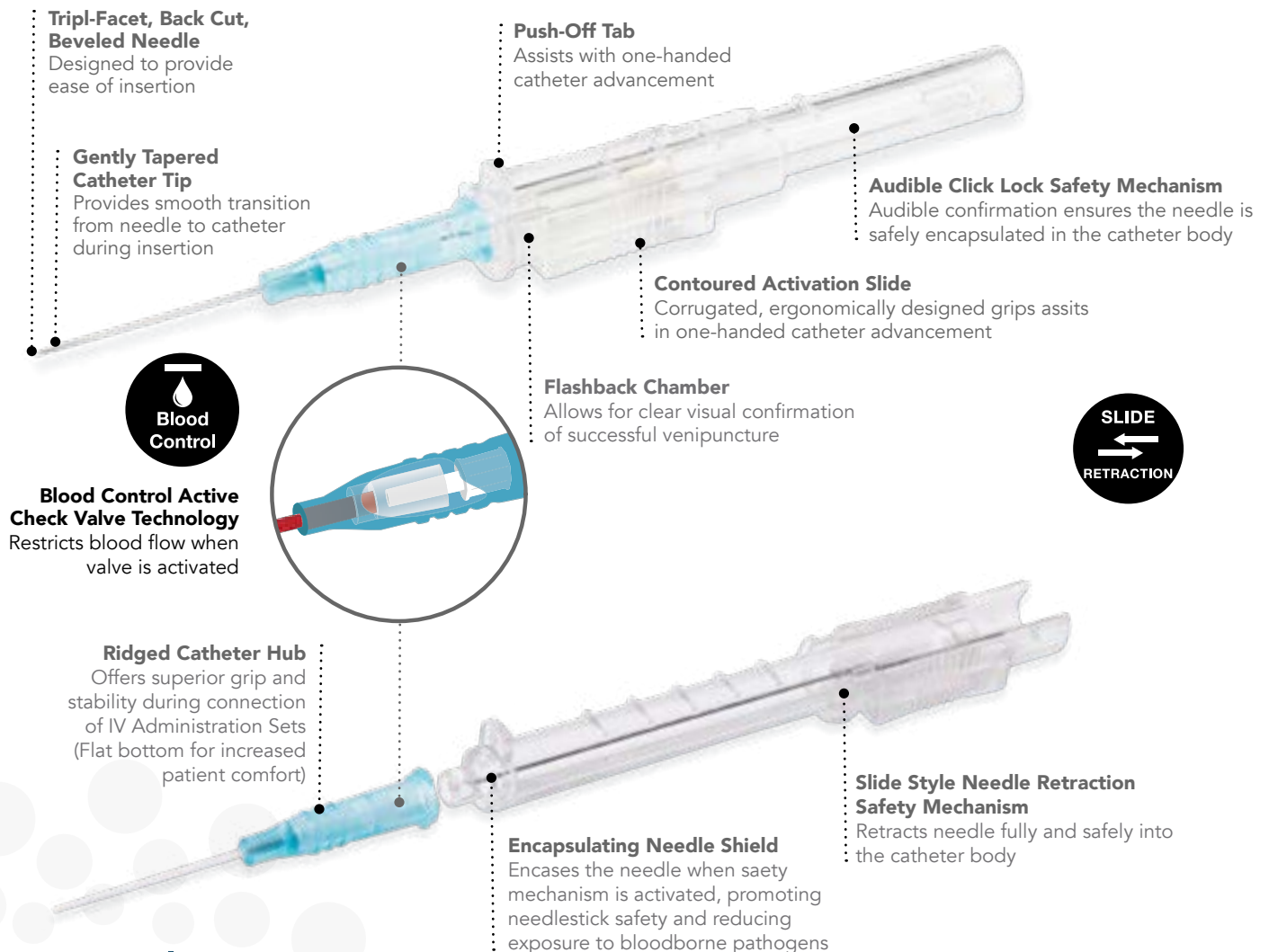

PUR (polyurethane) Catheter material

product specifications

- Incorporated blood control
- PUR catheter material
- Slide style needle retraction
- Ground stainless-steel needle
- Straight hub
- Disposable
- Non-pyrogenic
- Not made with natural rubber latex
- Not made with DEHP
- ISO 10555-5 compliant color-coding
- Needlestick Safety and Prevention Act (NSPA) of 2000 compliant



ordering information

Color	Item #	Gauge and Length	Catheter ID (mm)	Catheter OD (mm)	Gravity Flow Rate (mL/min)	Qty
	1613-86214	14G x 1.25"	1.6mm	2.1mm	297mL/min	1/ea, 50/bx, 200/case
	1613-86216	16G x 1.25"	1.38mm	1.8mm	220mL/min	1/ea, 50/bx, 200/case
	1613-86218	18G x 1.25"	0.95mm	1.3mm	94mL/min	1/ea, 50/bx, 200/case
	1613-86220	20G x 1.25"	0.78mm	1.1mm	61mL/min	1/ea, 50/bx, 200/case
	1613-862202	20G x 1"	0.78mm	1.1mm	61mL/min	1/ea, 50/bx, 200/case
	1613-86222	22G x 1"	0.62mm	0.9mm	36mL/min	1/ea, 50/bx, 200/case
	1613-86224	24G x 0.75"	0.49mm	0.7mm	20mL/min	1/ea, 50/bx, 200/case

